



EM702

Compact Stereo System

OWNER'S MANUAL
MODE D'EMPLOI
MANUEL DEL USUARIO
BEDIENUNGSANLEITUNG

ENGLISH

FRANCAIS

ESPAÑOL

DEUTSCH

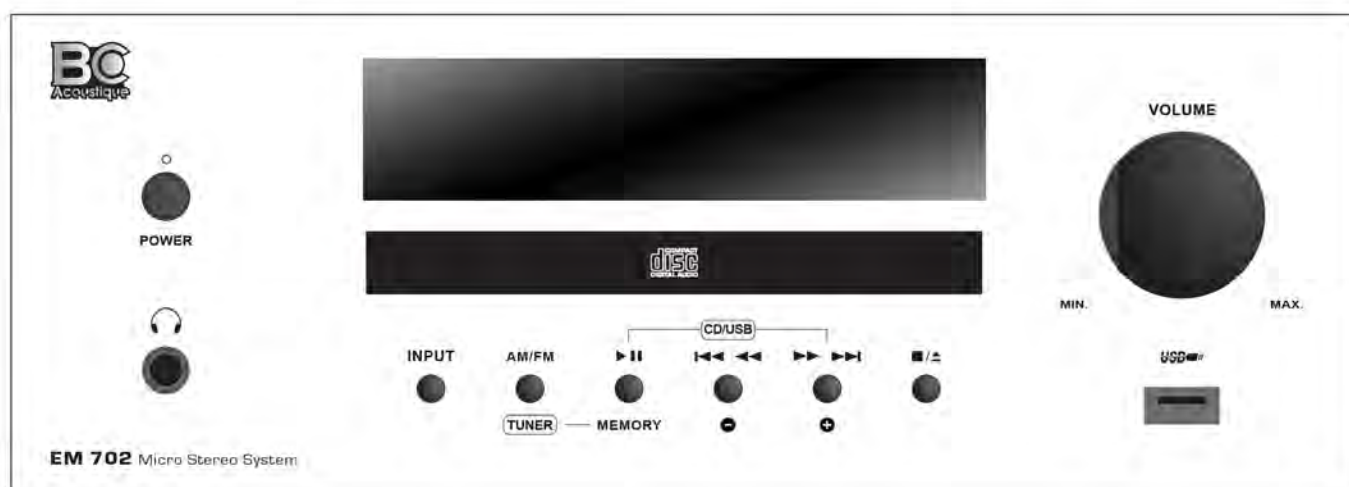

Dear Customer,

Thank you for choosing a BC Acoustique product. Its implementation has been our know-how, both in terms of design to the manufacturing. Electronic components and mechanical parts correspond to the selection criteria of very high quality. Operation and finish of each product have been checked before delivery. To obtain best results, please read the advice contained in this document.

Summary

Safety Instructions	02
Glossary	02
Recommandations	02
Recycling product	03
Location and precautions	03
Power Sources	03
Warranty	03
Basic Instructions: QUICK START	04
Rear panel - Connections	04
Front panel - Connections and uses	06
Under the amplifier - Switch anti-hum (Ground On/Off) ...	07
Remote Control	08
Listening to the CD Player	09
USB playback	10
WIRELESS device playback	10
Listening to the radio	11
Specifications	12
Troubleshooting	13
Advices	13

Safety instructions

We invite you to read the instructions on the proper use of your product carefully. They will ensure the proper functioning of the latter and it safely.

- Do not use this device in a wet area or near water.
- Clean only with a dry cloth. As a precaution it is best to unplug the unit before handling.
- Never cover the ventilation of the unit. Be sure to install the unit in a well ventilated location.
- Do not install near heat sources.
- Take great care of the power cord and plugs electrical connection. In particular, do not walk, or press the power cord, specifically at plugs, power plant and the output of the power supply.
- Use only parts and accessories recommended by BC Acoustique.
- Be sure to use an appropriate power supply to the power jack on the unit outlet. Especially if the device is equipped with a ground, it is necessary to use it.
- Unplug the apparatus during lightning storms or when not in use for a long time.

Glossary

 The CE mark indicates that this product complies with European directives called «low voltage» (2006/95/EC), Electromagnetic Compatibility (2004/108/EC) and apply eco-design requirements for energy products (2009/125/EC) when the appliance is installed and used in accordance with the user manual.

For continued compliance only BC Acoustique accessories must be used with this product and servicing must be performed by specialized and qualified staff.



The WEEE symbol is that of the European Union regarding the recycling of electrical and electronic equipment. It indicates that this product contains electrical and electronic components that can be reused, recycled or recovered. Therefore this product should not be disposed of in your regular trash. Thank you to return the unit or contact your authorized dealer for more information.



This symbol alerts the user to the presence of «dangerous voltage» uninsulated which may pose a risk of electric shock to the user.



This symbol alerts the user that the documentation that comes with the device contains important instructions for maintenance and proper use of the product.

Recommendations

In the case of headphones, do not use it to excessive noise. Otherwise, prolonged listening at high volume levels may cause permanent damage to your hearing.

When disposing of used batteries, please comply with governmental regulations or rules defined by the public statements relating to the environment applicable in your country.

Never expose the batteries (battery pack or batteries installed) to excessive heat such as sunshine, fire, etc ...

Product recycling

At the end of its useful life, this product should not be disposed of with regular garbage, but returned to a collection point for the recycling of electrical and electronic components. This point is emphasized by the symbol on the product, the instruction manual and on the packaging.

The materials can be reused in accordance with their markings. Through reuse and recycling of raw materials or any other form of recycling, you make an important contribution to environmental protection. Your municipality can tell you where is the point of the nearest collection site.

Location and precautions

Avoid placing it in direct sunlight or near a heat source. No source of light shall be placed on the apparatus. Also avoid all sources that could cause vibration, dust, cold or moisture. The recommended ambient temperature range is 5-35 °C.

The device must be installed on a stable, level surface. Do not place the unit on an unstable surface or shelf. The unit may fall, causing serious injury to a child or adult as well as serious damage to the product. Do not place other equipment on top of the unit.

Due to stray, turntables or CRT TVs magnetic fields should not be located near the unit to avoid possible interference.

Power sources

The unit should be operated only from the type of power source indicated on the label. If you are unsure of the type of power available to you, thank you to contact your dealer or the company responsible for the power supply in your area.

Turn off device if you do not intend to use this unit for a long time.

In case of prolonged absence from home, it is recommended to unplug from the electrical outlet.

Make sure each cable is correctly inserted. To prevent hum or background noise, do not mix different other antenna cable with the power cord or speaker wires.

Warranty

BC Acoustique warrants this product parts and labor (under the conditions specified below).

BC Acoustique will repair or replace (at its discretion) this product or any defective parts. The warranty period may vary by country. If in doubt, contact your dealer. Always retain proof of purchase of this product.

For warranty service, please contact the BC Acoustique authorized reseller from which you purchased this product. If your dealer is not itself repair the product, it can be sent to BC Acoustique authorized after-sales service. If necessary, you will need to ship this product in its original packaging or packaging affording an equal degree of protection.

Proof of purchase such as an invoice stating that the product is covered by the Guarantee must be presented for any warranty claims.

This warranty is void if:

- The factory serial number has been altered or removed.
- This product was not purchased from an authorized reseller BC Acoustique. To confirm that the serial number has been altered or that the product was purchased from an authorized reseller BC Acoustique, you can call BC Acoustique or distributor in your country.
- If the power supply cord or plug is damaged.
- If liquid has been spilled or if objects have fallen inside.
- If the unit has been exposed to rain or water.
- If the unit is dropped or damaged in any way.
- This warranty does not cover cosmetic damage or damage caused by or due to force majeure, an accident, mis use, abuse, negligence, commercial use or modification of part any product.
- This warranty does not cover damage caused by or resulting from misuse, a maintenance or improper installation or repairs made or attempted by anyone other in BC Acoustique or not BC Acoustique dealer or technician approved, authorized to carry out maintenance and repair under warranty for BC Acoustique. Any unauthorized repairs will void this warranty. This warranty does not cover products sold «AS IS».
- REPAIR OR REPLACEMENT AS PROVIDED UNDER THIS WARRANTY IS THE EXCLUSIVE REMEDY OF THE CONSUMER.
- BC ACOUSTIQUE NOT BE LIABLE FOR ANY INCIDENTAL OR CONSEQUENTIAL DAMAGES.

Warranty

- Some countries do not allow the exclusion or limitation of incidental or consequential damages or exclusions of implied warranties. Therefore, the limitations or exclusions herein may not apply. This warranty gives you specific legal rights, in addition to other rights which vary from state to state or country to country.

Basic instructions Quick starting guide

Make sure that the device is not plugged into the mains before making any connections. It is also recommended to turn off or disconnect all other devices associated while making connections to the product.

Connect the speakers to the speaker terminals on the back and the sources of the corresponding input jacks on the back.

IMPORTANT: Make sure you have set the voltage selector ⑧ to suit your country: INPUT VOLTAGE: **AC110 (USA)** and **AC230 (EUROPE)**.

Connect the power cord to the connector on the one hand AC Mains product and the other to a wall outlet. Turn the POWER switch ③ on the ON position.

If the unit is equipped with a standby, then press the STANDBY button to turn it on.

Press the input selector for the source you want to hear.

Connections to the stereo system

① SUBWOOFER OUTPUT

Connect this output to your active subwoofer.

② ANALOG INPUT (RCA)

Analog input is designed to connect sources «line level» to your amplifier. These inputs are designed for so-called «analog» signals (as opposed to «digital» signals). Compatible cables are made with these type «RCA», they are traditionally identified by a color code «RED» for the RIGHT channel and «WHITE» for the LEFT channel.

ANTENNAS (Connecting the AM and FM antennas)

③ **AM antenna:** Use internal or external AM antenna and connect there to one of the two terminals at the rear of the unit.

When using an outdoor antenna, always connect a grounding wire to the GND terminal. Leave the internal antenna connected even when also using a connected outdoor antenna.

④ **FM indoor antenna:** Connect the included FM antenna connector on the rear panel, deploy it and tune your favorite station. Fix the antenna to a suitable location such as a window frame or wall that gives the best reception and secure it.

FM outdoor antenna: In an area where FM signals are weak, it may be necessary to use an outdoor FM antenna. Use a three-element outdoor antenna (commercially available), or a five-element antenna in a area where radio signals are particularly weak, and use a 75 Ω coaxial cable to connect it.

Note: Disconnect the indoor FM antenna when using an outdoor antenna.

⑤ DIGITAL INPUTS

Your stereo system has a built-in digital-to-analog converter. Therefore it is possible to connect a digital source (such as most modern television screens).

To ensure compatibility with all existing types of digital terminals, the EM-702 has an "optical" socket and a "coaxial". However this entry is unique and it is possible to connect one device at a time.

The entry "optical" take precedence over the entry "coaxial" in case you have wired both.

Rear panel

WARNING: Be sure to turn off the power on your product before making any connections. Similarly it is best to cut the power of other devices you want to connect to your amplifier.

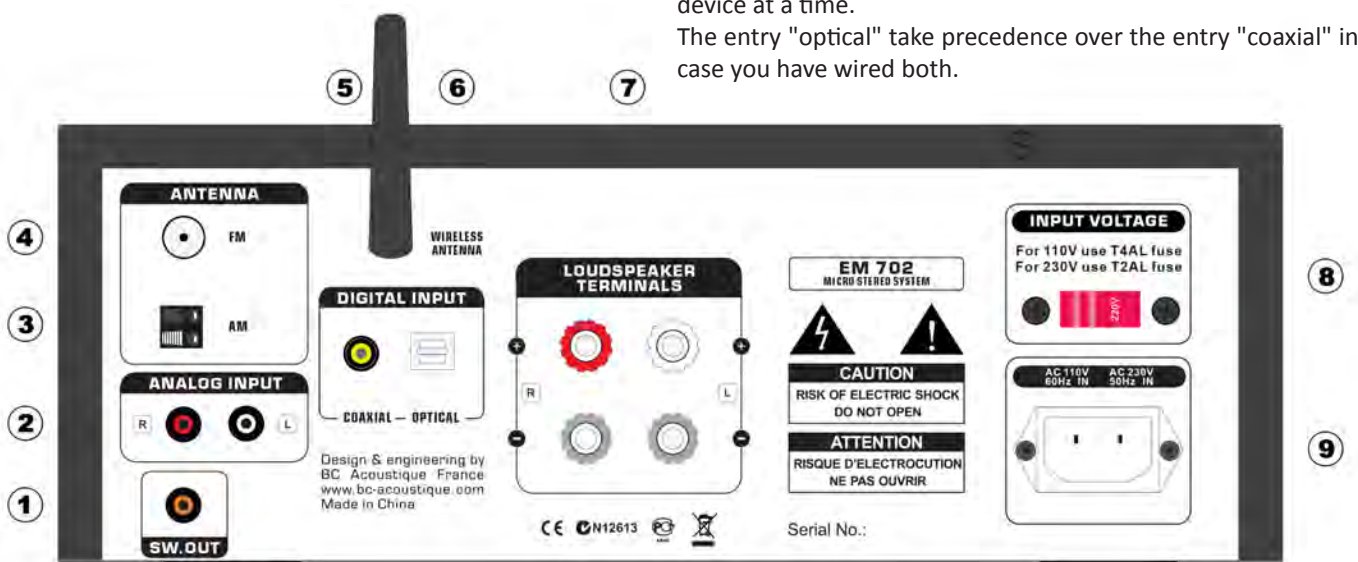

Connections

⑥ WIRELESS ANTENNA

This connector is for receiving a WIRELESS antenna. The supplied antenna is mounted directly to the back of the unit. The WIRELESS range is limited to few meters (depending on the nature of the obstacles located between the EM-702's antenna and your WIRELESS source).

It is possible to obtain an optional "WIRELESS long-range" antenna. It consists of a cable to shifting the antenna. Moreover, this antenna is larger.

⑦ LOUDSEPAKER TERMINALS

Connect the speaker to the terminals marked RIGHT "+ R" and "R -" ensuring that "R +" is connected to the "+" terminal of the enclosure and "R -" is connected to the terminal "-" the same enclosure. Connect the LEFT speaker to the terminals marked "L +" and "L -" by doing the same.

Make sure that no wires are not insulated can bypass the speaker outputs. Make sure that the speaker terminals are tight enough to ensure a good electrical connection. If the terminal screws are not tight enough, the sound quality may be affected.

Use only dedicated wire to the speaker (a section of 1.5 mm² or more is recommended especially if the cable length is greater than 3m).

Important Note: Check the impedance of your speakers. When using a pair of speakers, you can use speakers with an impedance of between 4 and 8 ohms.

⑧ INPUT VOLTAGE

IMPORTANT: Before turning on your amplifier, check that you have positioned the voltage selector based on your geographic location: AC110V (USA, etc ...) and AC230V (EU, etc ...). Also be sure to use a fuse appropriate for the selected voltage sector.

Connections and uses

Example position voltage selector:

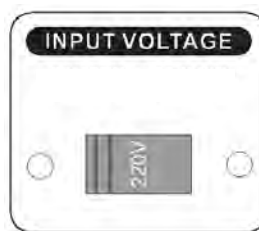

220V for Europe
fuse T2AL/230V

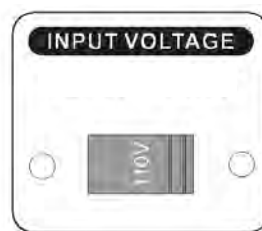

110V for USA
fuse T4AL/110V

⑨ AC MAIN INPUT

Once all connections to the stereo system, plug the power cable into an outlet and turn the unit on. Your EM-702 is now ready for use.

Front panel

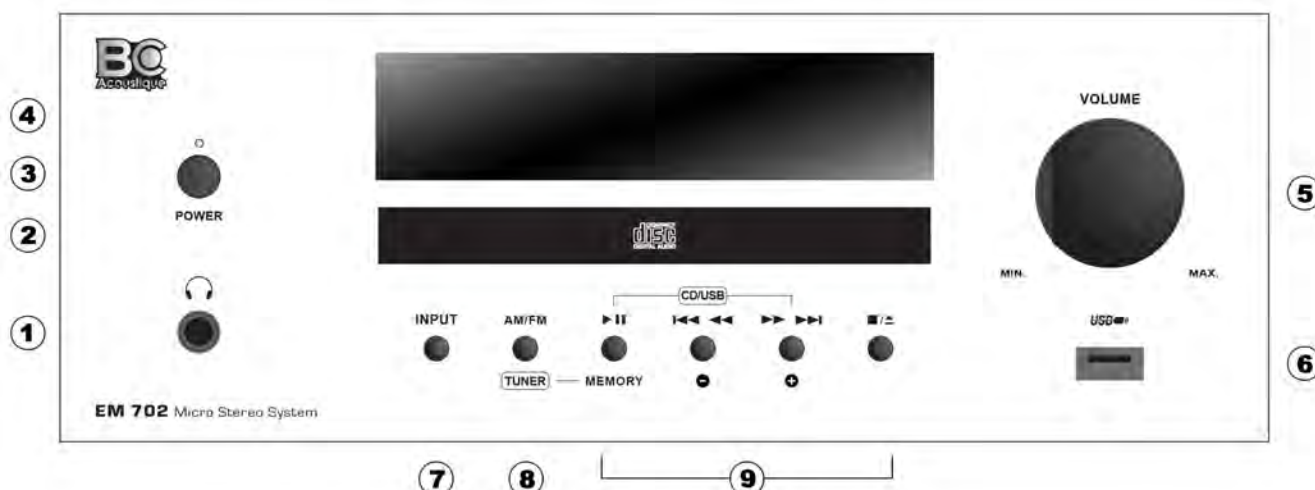

Connections and uses

① PHONE - HEADPHONES OUTPUT

Make sure the volume control is turned down before connecting or disconnecting headphones. Listening at high levels can cause permanent hearing damage.

This taken Jack size 6.35 mm allows connection of stereo headphones. It is advisable to use a listener with an impedance between 32 and 600 ohm headphones.

When the headset is connected, the output to the speakers are then cut.

② DRAWER DOOR CD

This drawer is designed to receive the CD. Caution should never manipulate the drawer by hand but still pass through the control buttons on the front panel or remote control to proceed to the opening or closing. When the DISC TRAY open insert a facing down on the CD tray.

If the message "No Disc" appears on the VFD drive, the disc is probably on the wrong side.

③ POWER - ON / OFF BUTTON

This switch allows shutdown or operation of the amplifier.

④ VFD DISPLAY

The VFD (Vacuum Fluorescent Display) display shows all the visual information on all major modes, settings and indicators of the stereo system.

⑤ VOLUME

This knob adjusts the output volume of the amplifier at the speaker outputs.

⑥ USB

Connect your USB flash drive here to play your digital files in MP3 and WMA formats.

⑦ INPUT - SOURCES BUTTON

This button allows you to select one of the sources of the EM-702 and the signal sent to the speakers and headphones. Each time you press the INPUT button, the mode changes as follows:

CD → TUNER → AUX ↴
↴ DIGITAL ← WIRELESS ← USB

You can also press the corresponding different sources buttons on the remote control.

SOURCES:

CD PLAYER

The CD player can play back recordings in MP3 / WMA CD-R or CD-RW. Refer to the "Listening to the CD Player" section of this manual for more information.

TUNER

Allows you to listen to FM RDS or AM radio. Refer to "Listening to the radio" section for more information.

AUX

This key activates the source connected to the RCA (line level) input of the same name located on the back of the stereo system.

USB

This button selects the listening to digital files you have stored on your USB drive that will be connected to the USB port on the front of the unit. For more information, refer to the section "USB Playback".

WIRELESS

This key enables the WIRELESS connection to listen to music from your smartphone or other wireless sources. For more information, refer to the "WIRELESS device playback" section.

DIGITAL

This button activates the digital input on the back of the amplifier. It allows listening to the digital source connected to the amplifier with integrated digital-to-analog converter.

⑧ TUNER CONTROL BUTTONS



AM / FM

Select AM or FM by repeatedly pressing the "AM / FM" button.

MEMORY

Press the "MEMORY" button to store a radio station. The letters "HE-M" will flash to let you use the buttons "-" or "+" to choose a number between 1 and 40 memory to store the station.

Once you have selected your desired preset number, press again the "MEM" button. It will appear on the screen "MME 03" if you chose to store, for example, your station in the memory 03.

Wait three seconds so that the display will jump to the selected FM or AM bandwidth so that you can continue your radios research and storages.

BUTTONS :

Use these buttons to search for stations or switch from one memory to another. For more information, see "Listening to the radio" part of this manual.

Connections and uses

⑨ CD/USB CONTROL BUTTONS



PLAY / PAUSE (▶||)

Press this button to start playback or resume playback after Pause. If the disc tray is open, press this button to automatically close the tray and start playback if the disc is loaded.

During playback, press this button to pause playback while maintaining the playhead to where it is on the disc surface. To resume playback at the exact time of the pause, press "PLAY / PAUSE."

SKIP / SCAN

Press ◀◀ or ▶▶ to move to the next or previous track. Forward or backward in an accelerated manner, hold the ◀◀ or ▶▶ button continuously. The optical pickup is then read before the recording or backward at high speed.

STOP

Pressing once on the "STOP" button stops playback and resets the playhead at the beginning of the disc. The display returns to the display of the number of tracks and total playing time on the disc. If you programmed the CD player to play a selection of tracks, the program will be stored in the player's memory.

In the programming mode, you can remove a program by pressing twice on the "STOP" key.

OPEN / CLOSE

Press this button to open and close the disc tray.

Under the amplifier

SWITCH ANTI-HUM (GROUND ON / OFF)

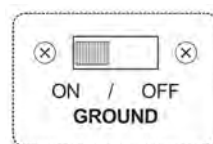

Your EM-702 has a mains socket outlet with a ground connection. The use of this type of connection is recommended for electrical safety reasons (including wetlands). However sometimes this connection «mass» is the origin of «hum» audible from the speakers in a hi-fi system to solve this problem, the cancellation of the ground connection is sometimes sufficient. To do this you have, under the device, a switch to choose to connect or not the mass of the device to the mains.

Remote control

The amplifier EM-702 comes with the RC-EX3.1 remote control.

Note on the battery: Remove the transparent protective tab to activate the battery.

- ① **POWER:** This button allows you to pause or resume from standby different electronic devices BC Acoustique with this feature.
- ② **LOUD:** Activates the LOUDNESS fonction
- ③ **STOP/EJECT**
- ④ **1...9.0:** Keypad / Track selection
- ⑤ **A-B :** Input (A) an output (B) selectors to play repeatedly this selection from a track.
- ⑥ **PAUSE/PLAY PREV NEXT STOP**
- ⑦ **MUTE:** Use this button to mute the sound. To cancel muting, press MUTE again or change the volume setting.
- ⑧ **TIME:** Displays the remaining time of the current track.
- ⑨ **Tuner's buttons:**
TU (-/+): Setting the radio frequency range
CH (-/+): To review stored stations
AUTO: Starts a scan forward until the next station
AM/FM: Press to select the band radio frequencies between FM and AM.
MEM: To store a favorite radio station
ST/MO: Switch between mono or stereo mode
- ⑩ **Sources selection buttons:**
WIRELESS/DIGITAL/CD/TUNER/AUX1/USB
- ⑪ **PROG:** In CD mode, or USB, use this button to enter playback mode Programmed device. To memorize the order of tracks to listen to, press "PROG" then the number of the desired track. Repeat until the end of your program, then press the "Play / Pause" button to start listening.
- ⑫ **⏮:** Skip to the previous track / file
⏭: Skip to the next track / file
- ⑬ **REPEAT:** Repeating the current track or all the tracks.
- ⑭ **▲: VOL +**
▼: VOL -
⏮: 9 seconds reward jump (CD/USB)
⏭: 9 seconds forward in the track (CD/USB)

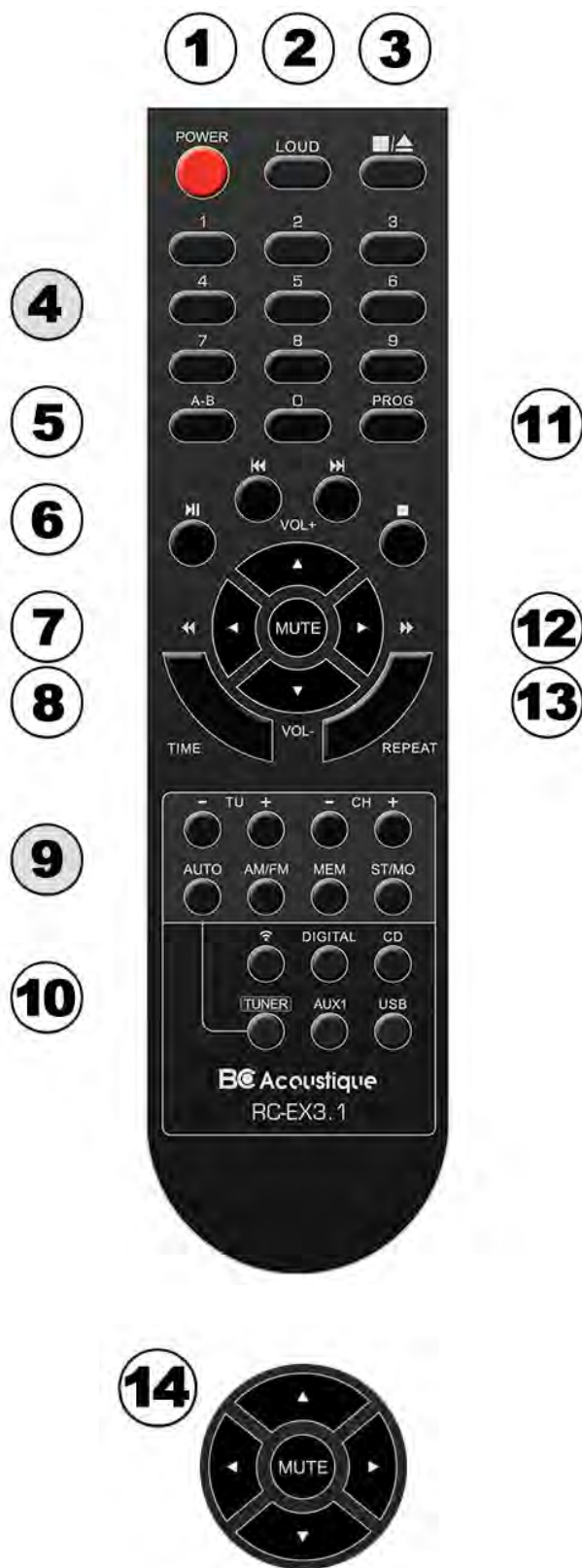

Listening to the CD Player

HANDLING DISCS

Do not touch the playback side of the disc. Hold the disc by the edges so as not to leave fingerprints on the surface. Never stick paper or tape on the disc.

STORING DISCS

After playing, store the disc in its case. Do not expose discs to direct sunlight or sources of heat and never leave it in a parked car in the sun.

CLEANING DISCS

Fingerprints and dust on the disc can cause low quality noises and sound distortion. Before playing, clean the disc with a clean cloth. Wipe the disc from the center outward.

Never use strong solvents such as alcohol, benzene, paint thinner, or a special cleaner commercially available or antistatic spray intended for vinyl records.

VFD DISPLAY

When you load a CD, the display shows the number of tracks and the total duration of CD (H-MM-SS).

DISC AUDIO CD-R & CD-RW

The EM-702 can read CD-R and CD-RW audio discs recorded on a computer or on a CD recorder. Audio quality CD-R or CD-RW discs varies widely which may affect readability.

Some factors affecting readability:

- The quality of the disc itself. Overall, blank CD-R/RW manufactured by renowned companies give better results than unbranded ones.
- The quality of the CD recorder or player / recorder to the computer. Some recorders and writers produce better results than others.
- The CD-R/RW recording speeds. In general, the quality of a CD-R/RW is best if recorded at low speed rather than a higher speed.

MP3/WMA PLAYBACK FORMATS

The EM-702 can play MP3/WMA formatted recordings on CD-R or CD-RW. You can mix all types of file on disk. Using the remote control, you can select the desired file and start playing in the following manner folder or MP3/WMA file:

- 1 - Load the disc in question.
- 2 - Press the arrows to select the desired folder.
- 3 - Press the arrows to select the desired file.
To access the files, the drive must be stopped "STOP" or during playback.
- 4 - Press "ENTER" to start playback. For each file, the EM-702 will display the file type and a corresponding icon on the VFD screen. Information such as title, album and artist name, if any, will parade on the VFD screen during playback.

Notes

- The number of files depends on the disc and not on the folder's name; in other words, the file number is assigned in order of reading on the disc.

- If you want to select the file number 9 on a disc that contains over 100 MP3/WMA files, you must enter the "009" number.

PROGRAMMING

The program function enables you to store 16 favorite tracks in the player's memory from any disk. When programming a sequence of songs, the EM-702 must be on "STOP" mode (no disc playing). Using the remote, enter the desired program sequence as follows :

- 1 - Press the "PROG" key for programming. The display shows "P01" and blink, which means that the EM-702 expects you to enter the first track to be programmed.
- 2 - Use the numeric keypad to directly enter the first track of your programming.
- 3 - The screen will then return to display "P02", indicating that the reader expects you to enter the second track of your programming.
- 4 - Repeat steps 2 and 3 to select and record additional tracks in memory, up to 16 tracks. If you try to program more than 16 tracks or files, the EM-702 pass directly in playback mode.
- 5 - Press "PROG" to finish or complete your programming.
- 6 - Press "START" key to start playback.

Notes

- To program MP3/WMA files, follow the same procedure, except for steps 2 and 3: the total number of files and the total playing time is not displayed during programming.

- If you want to select the file number 9 on a disc that contains over 100 MP3/WMA files, you must enter the "009" number.

- If you press the "STOP" button during the programming procedure, the program will stop and all files (or all tracks) scheduled date will be deleted. The LCD will return to displaying the total number of tracks and the total playing time of the CD audio, or the total number of files for MP3/WMA CD.

- If you press twice the "STOP" button during playback of the programmed tracks, the entire program list will be deleted.

Listening to the CD Player

PLAY YOUR PROGRAM

1 - To play your program, press the "PLAY" button while you are in "PROG" mode.

During playback of a program, by using the « SKIP » keys, **I◀◀** or **▶▶I**, you will only go from track program to another track program.

2 - If you want to read only a portion of a recorded program, play and press the « SKIP » keys, **I◀◀** or **▶▶I**, to move the programmed tracks you do not want to read.

STOP OR DELETE PROGRAM

1 - To stop the program, press once "STOP". The recorded track list is kept in memory. If you want to listen to your program again, simply press "PLAY".

2 - To erase the program memory, use one of the methods below.

- Press "OPEN" to open the disc tray.
- Turn off the CD Player.

USB playback

TYPE OF KEY USB

USB key must be formatted in FAT mode. NTFS mode is not recognized by the EM-702.

COMPATIBLE DIGITAL FORMAT: MP3 / WMA

The USB port can play digital files in MP3 / WMA format.

USB PLAYBACK

1 - On the front of the EM-702, repeatedly press the "INPUT" button to select "USB" on the VFD screen. Otherwise, press the "USB" button on the remote control.

"NO USB" will appear if no USB device is connected.

2 - Insert your USB key into the dedicated USB Slot for this purpose on the front of the stereo system.

3 - Press the play / pause key (**▶II**) to start playing if it does not start automatically when you insert the USB key.

Using the remote, you can select the desired file (MP3/WMA) and start playing the desired track/folder using the buttons **I◀◀** or **▶▶I**.

PROGRAMMING

Refer to previous page for manipulation to program tracks on a CD is the same as digital files on USB.

WIRELESS device playback

The EM-702 offers the possibility to listen wirelessly to music played by WIRELESS devices like Smartphones. These devices must be paired in order to communicate.

Note: You also need to run your other WIRELESS device to pair to the EM-702.

PAIRING YOUR WIRELESS DEVICE

1 - On the front of the EM-702, repeatedly press the "INPUT" button to select "WIRELESS" mode. Otherwise, press the button WIRELESS  on the remote.

2 - Turn on WIRELESS communication on the other WIRELESS device (your smartphone, tablet ...).

Your device should automatically receive the EM-702 WIRELESS signal.

3 - Select the device named "BC-EX702" on your WIRELESS device to connect the stereo system.

If you have not managed to connect or see the EM-702 on the screen of your device, you have to start pairing again (step 1).

Note: If another WIRELESS device had already managed to connect the EM-702 will automatically try to reconnect to the same device.

Listening to the radio

LISTENING TO THE RADIO

1 - Repeatedly press the "INPUT" button to select TUNER. If you use the remote control, press the "TUNER" button.

2 - Keep pressing the "-" or "+" key until the automatic mode snaps (scroll continuous radio frequency). Auto Tuning will stop on the first radio it finds.

Press the "-" or "+" to increment the stations you've already stored.

SETTINGS - PRESETS

1 - To store a radio station, select AM or FM by pressing the "AM / FM" key until the desired band is displayed on the VFD display.

2 - Keep pressing the "-" or "+" key until the automatic mode is switched on and the EM-702 is the first stop on radio it finds.

3 - If this radio station does not suit you, search again from step shown just above (step 2).

If this radio station suits you, and if you wants to store it, press the "MEM" button.

The letters "HE-M" will flash to let you use the "-" or "+" keys to choose a number between 1 and 40 presets to store the station.

Once you have selected your desired preset number, press again the "MEM". It will appear on the screen "MS 03" if you chose to store, for example, your station in the preset 03.

Wait three seconds so that the display is repositioned on the selected band (FM or AM) so that you can continue your research and storages radio stations.

4 - SEARCH MODE STEP BY STEP

This research mode is available only from the remote control via the buttons "- TU +".

Note: You have 40 preset slots for storing your favorites radio stations (AM or FM).

SELECTING A PRESET

When the EM-702 is in Tuner (AM or FM shown on the VFD screen), briefly press the "-" key or "+" to select the stations you've already stored.

SETTINGS AM BAND for EUROPE or USA

By pressing the "LOUDNESS" key during 3 seconds, you will see USA or EUROPE noted on the screen. This will determine the frequency ranges available depending on your location.

For EUROPE the frequency ranges are from 522 kHz to 1620 kHz and the increment is by 9 KHz steps.

For USA, the frequency ranges are from 530 kHz to 1710 kHz and is the increment is by 10 KHz steps.

FM RDS

The display of the station name is intermittently with the display of the selected FM frequency.

FM INDOOR ANTENNA

Connect the FM antenna to the 75Ω FM socket at the rear panel of the EM-702 to extend the lead and tune in your favorite stations. . Adjust the antenna in a suitable location like a window frame or a wall until the reception is best and then fix the antenna in that position. This antenna is supplied with the EM-702.



FM OUTDOOR ANTENNA

If you live in an area where FM signals are weak, it may be necessary to use an outdoor FM antenna.

Generally a 3 elements antenna will be sufficient but if you are living in a area where FM signals are particularly weak, it may be necessary to use one with 5 or more elements.

Note: Disconnect the FM indoor antenna when using an external antenna.

AM INDOOR ANTENNA

Connect the antenna to one of the two terminals on the back of the EM-702.



Place the antenna on a shelf or hang it on a window frame and turn it in the direction which gives the best reception. Keep all other wires such as power cords, speakers wires or interconnect wires as far away as possible from the antenna.

The antenna wire should be fitted outdoors or indoors near a window. For better reception, connect the GND terminal to a reliable ground.

Note: If a loop antenna is insufficient to get a good reception, it may be necessary to use an outdoor AM antenna. In this case, even when using an outdoor AM antenna, it is not necessary to disconnect the AM loop antenna. Keep both antennas connected to the EM-702.

Specifications

Amplifier section

Output Power: 2x40W (6Ω, 1kHz, 0.5%)
Input sensitivity: 340 mV/47 KΩ
Frequency response: 20 Hz - 20 KHz
Compatibility range speaker impedance: 6-8 Ω

Tuner section

FM RDS

Tuning range: 87.5 MHz - 108 MHz
Mono signal to noise ratio: 56 dB
Stereo signal to noise ratio: 52 dB

AM

Signal to noise ratio: 35 dB

EUROPE

Frequency ranges: 522 kHz - 1.620 kHz 9 KHz steps

USA

Frequency ranges: 530 kHz - 1.710 kHz 10 KHz steps

CD Player section

Output level: 2V
Frequency response (Ref. 0dB, 20Hz – 20kHz): + 0,5 dB
Total harmonic distortion (Ref. 1kHz) <0,0025%
Signal to noise ratio (A, ref. 1kHz): 110dB
Balance between channels (Ref. 0dB, 1kHz): + 0,5dB
Dynamic range: 96 dB

USB flash drive

Type-A Format: FAT
Frequency response: 20 Hz - 20 KHz, +/- 1 dB
Signal to noise ratio: 80 dB or more

Connector WIRELESS, to use with your Smartphone, tablet, computer or other WIRELESS devices.

Transmission range: 10 m or less unobstructed.

Note: The transmission range is approximate and the surrounding environment and other electromagnetic waves might affect it.

Playable files CD/USB

MP3

Format: MPEG-1 Audio Layer 3
Sampling rate: 44.1 or 48 kHz
Bit rate: 320 kb/s or less

WMA

Sampling rate: 44.1 kHz
Bit rate: 192 kb/s or less

Connections

Front

1x Headphones output (stereo jack 6,35 mm)
1x USB input (Type-A)

Rear

1x RCA AUX line stereo input
1x Digital input: 1x Optical & 1x Coaxial
1x WIRELESS antenna
1x Subwoofer output
1x Indoor FM antenna
1x Indoor AM antenna
1x IEC Detachable power cord
4x Speaker terminals screw-compatible banana plugs

Included accessories

1x Detachable power cord
1x WIRELESS antenna
1x Indoor FM antenna
1x Remote control EX-RC3.1
2x Batteries (AAA) for remote control
1x Manual guide

General

Dimensions (W×H×D): 280 x 99 x 310 mm
Weight: 5 kg

EAN CODE

EM-702 BLACK: 0634654606167

Specification and appearance are subject to change without notice. Weight and dimensions are approximate. Illustrations in this manual might differ slightly from production models.

Troubleshooting

Here you will find a number of fault description and possible solutions we invite you to read in order to ensure the possibility of an actual breakdown of your device.

The unit does not turn on

- Make sure the power cord is properly connected.
- Make sure the plug is fully inserted into the wall outlet and there is power.
- Make sure the camera is turned on.
- Check the fuse in the mains plug or adapter if necessary.

There is no sound

- Make sure the unit is not in standby mode.
- Check that the source component is connected properly.
- Make sure your speakers are properly connected.

One channel no sound

- Make sure the balance control is in the correct position.
- Check the speaker connections.
- Check interconnects.

A loud humming or buzzing is noticeable

- Make sure that interconnect cable is loose or defective.
- Make sure your tape deck or turntable is not too close to the amplifier.
- Check turntable or tonearm to capture an ground fault or a faulty connection.

The bass is weak or the stereo image is diffuse

Make sure the speakers are not in phase.

The sound is distorted

Make sure that the control settings of volume or tone is not too high.

The remote control does not work

- Check that the batteries have not expired.
- Make sure nothing is blocking the remote sensor.

Jumps during playback

- Make sure the CD is not subject to vibration or external shocks from external sources.
- Check if the disc is not scratched.

WIRELESS - The sound stops or there is noise

If a device such as a microwave oven or wi-fi transmitter generates electromagnetic waves near the 2.4 GHz band, it can affect the connection or broadcast quality. In this case, install the EM-702 at a greater distance from this unit.

WIRELESS - The transmission is interrupted

- The device connected to the EM-702 is perhaps too far. The approximate distance transmission WIRELESS is about 10m without obstacles.
- Make sure there are no obstacles between the EM-702 and your WIRELESS device.

In case the above solutions do not remedy your problem, check our FAQ section (Frequently Asked Questions) on our website: www.bc-acoustique.com

For repair, during or after the warranty, please contact your dealer.

To obtain warranty service and technical support, thank you kindly to register your product online on the website www.bc-acoustique.com at the product registration section.

Advices

EJECT THE DISC

When CD is selected as the source, you can eject the disc.

FOLDERS ON CD

The EM-702 will play all your MP3 & WMA tracks from a data CD either the files are in folders or in roots.

Notes



BC ACOUSTIQUE
14 Avenue de l'Europe
77600 Bussy Saint-Georges - France
www.bc-acoustique.com